

Bromley Drive, Leigh, WN7 5NA
Offers Over £200,000

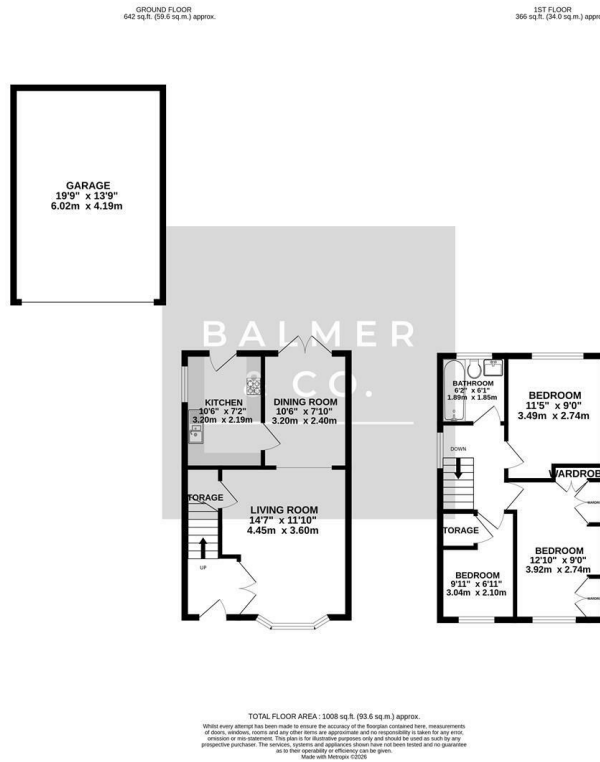

BALMER & CO in LEIGH are delighted to offer FOR SALE this fantastic three bedroom semi-detached house situated in a quiet residential area in Leigh. Immaculately presented throughout, this property has been very well maintained by its current owners and simply must be viewed. Comprising in brief of entrance hallway, large living room with gas fireplace and surround, separate dining room with French doors leading to the rear garden, with a modern fitted kitchen with integrated appliances completing the ground floor. To the first floor is a large master bedroom with fitted wardrobes and storage, second double bedroom, this single bedroom, with a three piece family bathroom completing the accommodation on offer. Externally the property is garden fronted with a long driveway to the side providing ample off-road parking, whilst to the rear there is a fully enclosed, East facing garden with a large detached garage. The property is ideally located within walking distance of Twelve Apostles RC Primary School and is close to other shops and amenities. Early viewings highly recommended, all enquiries welcome.

Floor Plan



Area Map

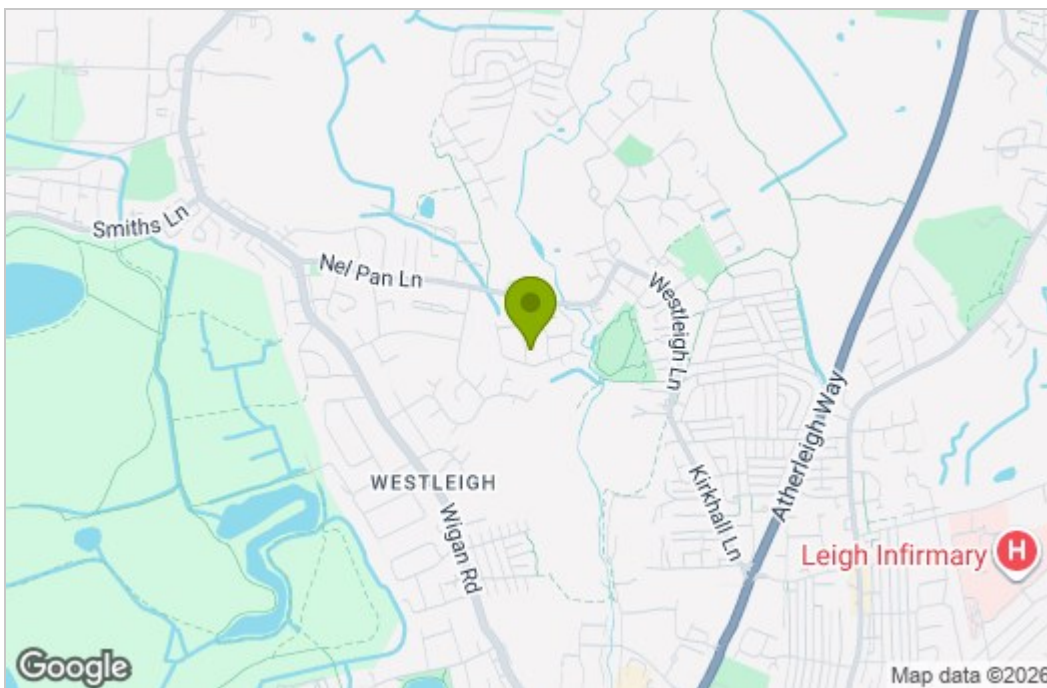

Energy Efficiency Graph

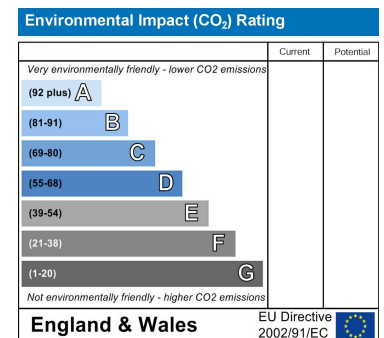
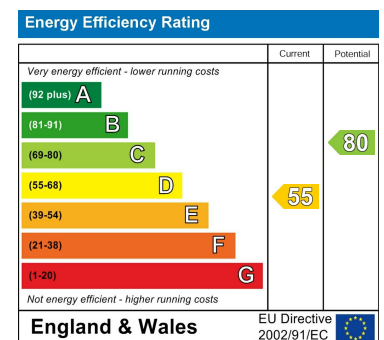

These particulars, whilst believed to be accurate are set out as a general outline only for guidance and do not constitute any part of an offer or contract. Intending purchasers should not rely on them as statements of representation of fact, but must satisfy themselves by inspection or otherwise as to their accuracy. No person in this firm's employment has the authority to make or give any representation or warranty in respect of the property.